

DWG. NO. SD 87531-0001
 CAD FILE S875310.DGN

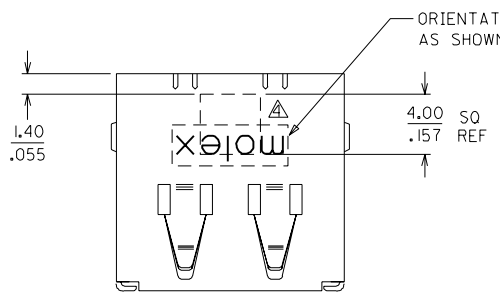

ORIENTATION OF MOLEX LOGO COULD BE AS SHOWN OR REVERSE IN DIRECTION

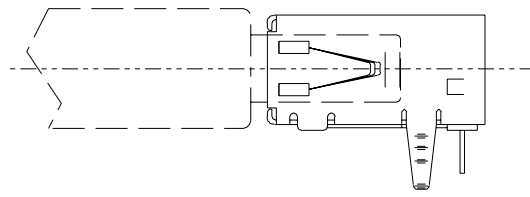

NOTES

1. MATERIAL

CONTACTS - PHOSPHOR BRONZE
 SHELL - COPPER ALLOY OR EQUIVALENT
 HOUSING - HIGH TEMP THERMOPLASTIC, NYLON
 94V-0, COLOUR: WHITE

2. PLATING

CONTACTS -
 GOLD FLASH OVER 0.76 μ m MIN PALLADIUM NICKEL
 IN MATING AREA, 2.50 μ m MIN TIN-LEAD ON
 SOLDER TAILS ALL OVER 1.27 μ m MIN NICKEL
 SHELL -
 2.50 μ m MIN TIN-LEAD OVER 1.25 μ m MIN NICKEL

3. FOR PCB THICKNESS OF 1.60mm.

Δ APPROXIMATE AREA FOR PICK & PLACE NOZZLE

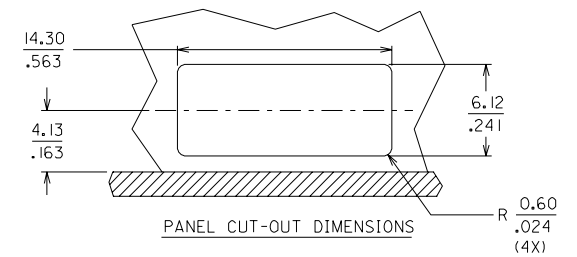

PANEL CUT-OUT DIMENSIONS

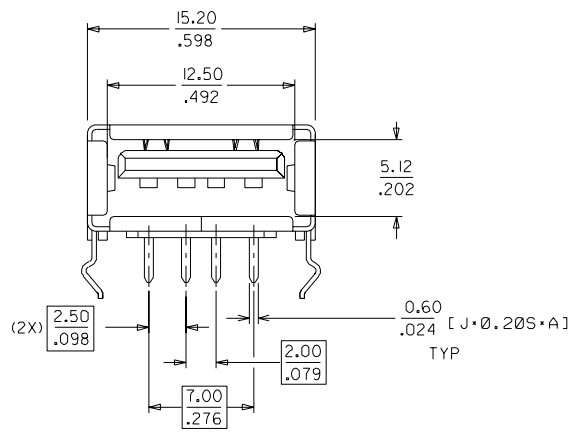

RECOMMENDED PCB LAYOUT

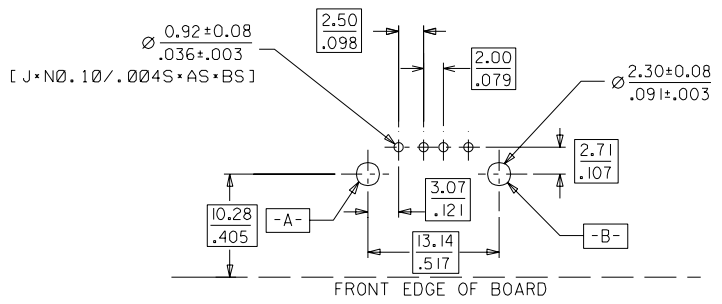

FRONT EDGE OF BOARD

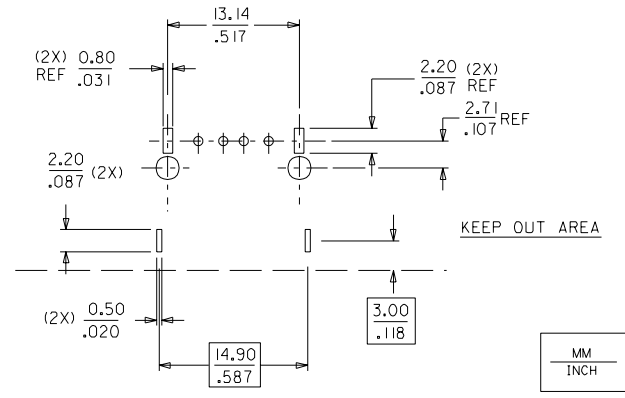
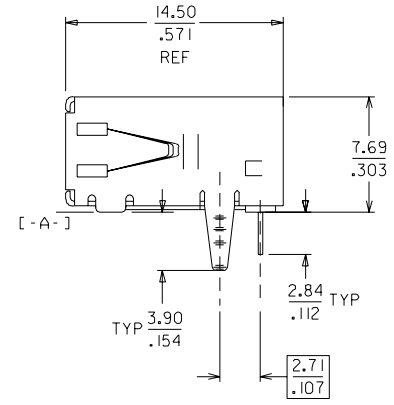

KEEP OUT AREA

MM
INCH

A5	ADD LOGO PER ECN S99-0224	-	LINE	981217	MATERIAL :	SEE NOTES ABOVE	
A4	REVISED PER ECN S1998-0113	-	LINE	970916			
A3	UPDATE DRAWING	S70266	LINE	961216			
A2	REMOVE PLATING OPTIONS	S70194	LINE	961016			
A1	CHG. SHELL PLTG. THICKNESS	S60573	LINE	960612			
A	ADD PLATING OPTIONS	S60506	LINE	960424	FINISH :	SEE NOTES ABOVE	
3	ADD PICK & PLACE AREA	S60433	POP	960313			
2	ADD KEEP OUT AREA	S60370	POP	960123			
1	PROPOSAL	S60302	POP	951208			
LTR	REVISION RECORD	ECN	DR	DATE	DRAWN BY ER POH 951208	CHK'D BY SK TOH 960109	GENERAL TOLERANCES \pm 0.20/.008
			CHK		APPR'D BY ROY 960109	SCALE 3 : 1	DWG. NO.: SD 87531-0001
REVISE ONLY ON CAD SYSTEM					TITLE : UNIVERSAL SERIAL BUS SINGLE RIGHT ANGLE RECEPT.,		

MOLEX SINGAPORE PTE LTD
 SHEET 1 OF 1

REV A5

DO NOT SCALE DRAWING